

Solar Flyhorse Light

CE  IP65 RoHS FC



	Type	RS-FH100	RS-FH120	RS-FH150	RS-FH200	RS-FH240
Panel	Power	100W/18V	120W/18V	150W/18V	100W*2pcs/18V	120W*2pcs/18V
	Material	Mono crystalline silicon	Mono crystalline silicon	Mono crystalline silicon	Mono crystalline silicon	Mono crystalline silicon
	Solar cell efficiency	19-20%	19-20%	19-20%	19-20%	19-20%
Lithium battery	Capacity	380WH	460WH	610WH	690WH	1200WH
	Charge cycle times	2000 times	2000 times	2000 times	2000 times	2000 times
Lamp head	Luminous flux	5800-6100lm	7500-7700lm	9100-9300lm	10000-11000lm	13000-14000lm
	Light output	30W	40W	50W	60W	100W
	LED qty	150pcs				
	LED chip	Bridgelux 210lm/w				
	Color temperature	3000-6000K				
	CRI	≥70Ra				
	Material of lamp head	Die-cast aluminum				
	Elevation angle	17° (attention to Dialux use)				
Lifespan	50000hrs					
System	Light control voltage	5V				
	Light distribution	Batwing lens with polarized light				
	Beam angle	X-axis: 158° Y-axis: 62°				
	Lighting time(full charged)	3-4 rainy days				
	Operation temperature	-20°C~60°C				
Installation	Top diameter of pole	80mm				
	Mounting height	6m	7m	8m	9-10m	11-12m
	Installation spacing	20m	25m	25m	30m	35-40m

6 working modes



- DEMO:** No matter day or night, light "on" for 1 minute. Only for test use.
- OFF:** Light "off", no matter day or night.
- L:** At night, 100%-2hr, 70%-2hrs, 30%-dawn.
- T:** At night, 100%-1hr, 70%-2hrs, 40%-3hrs.
- M:** At night, 50%-1hr, 100%-3hrs, 30%-dawn.
- U:** At night, 100%-1hr, 70%-3hrs, then sensor working, 50% if people come, 20% stand-by.

Precise installation

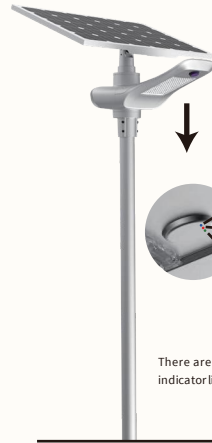

There are three indicator lights

LED light	Indications	Status	Functions
Blue	Charging indication	Long-term On	Be charging
		Long-term Off	Battery full charged
RED	Battery indication	Long-term On	Battery works normally
		Long-term Off	Battery is not connected/No power
		Fast twinkling	Battery is over discharged
		Slow twinkling	Battery full charged
Green	Load indication	Long-term On	Load is on
		Long-term Off	Load is off

System faults include:

1. Over discharging of battery.
2. System overvoltage.
3. LED load in short circuit.
4. LED load in open circuit.

Application

